



**TCA** QUADRANT  
AIRBUS EDITION



**TCA** QUADRANT ADD-ON  
AIRBUS EDITION

# CALIBRATION

1. Unplug your device



2. Link Both Add-ons using the provided SATA connection cables

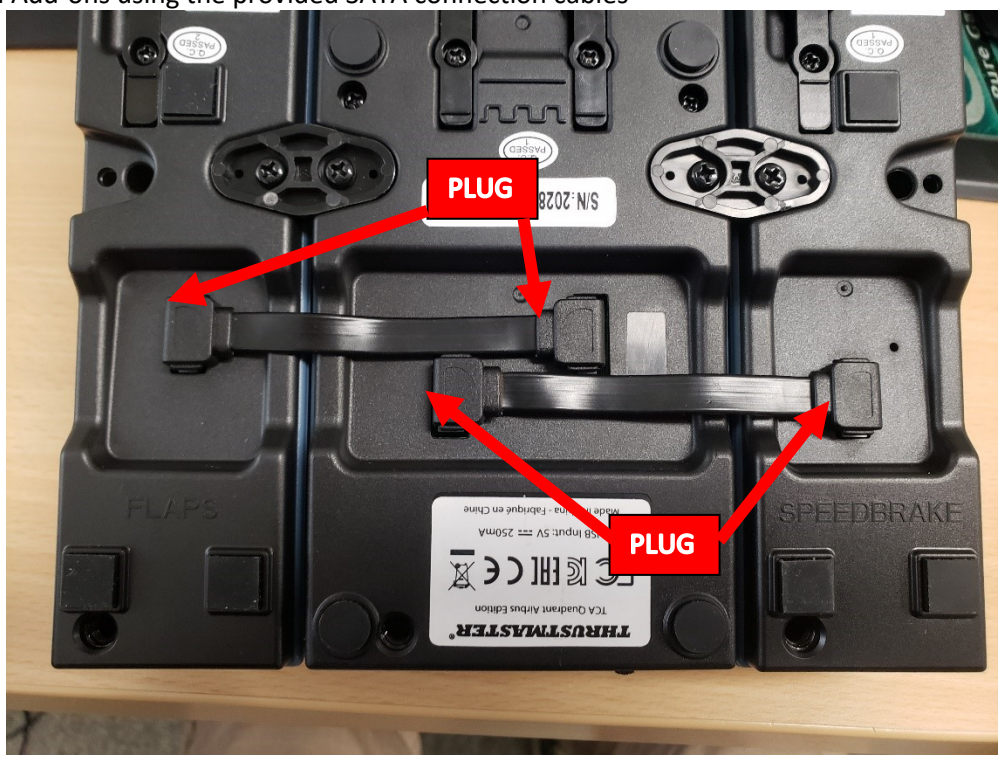



3. Set the Landing Gear toggle to the "DOWN" position



4. Link Both Throttles using the provided crossbar

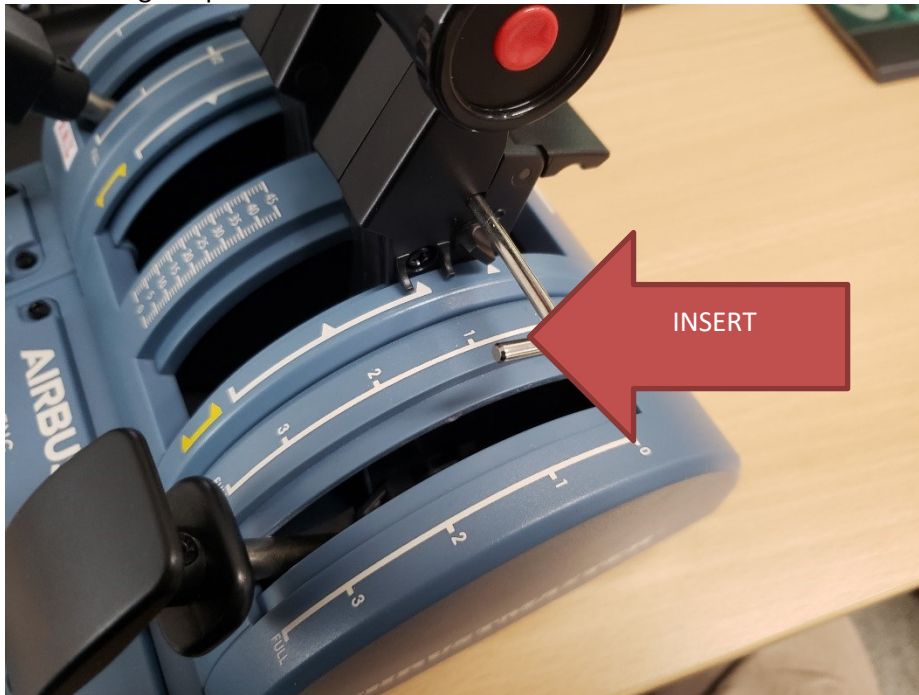



5. Move the 2 throttles, the spoiler and flaps arms at the lower position as shown:

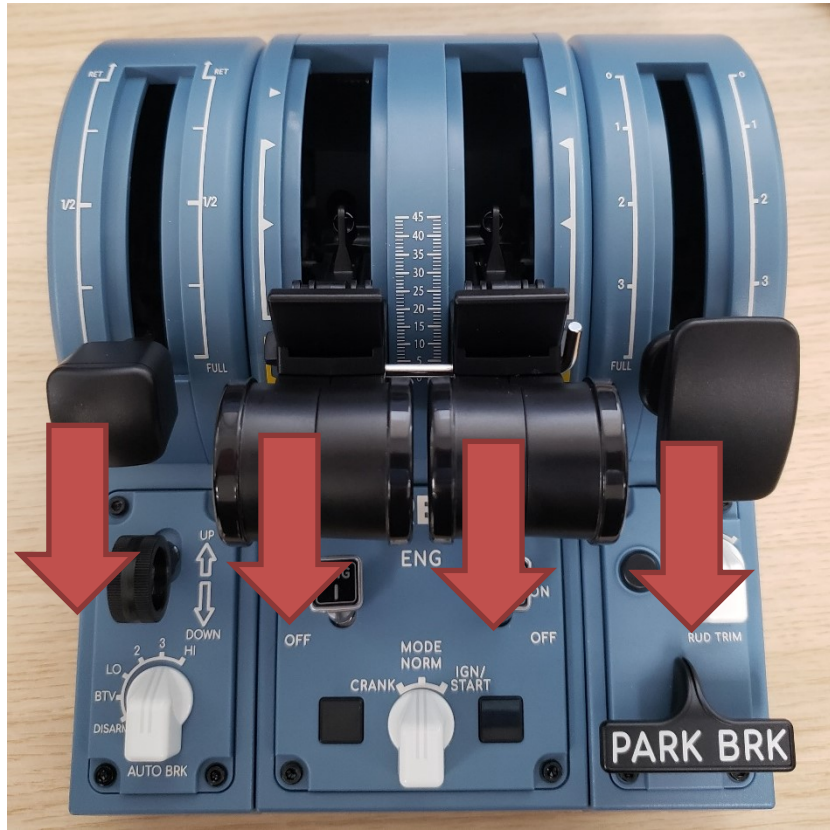

6. By having the firefault2 button pressed down, plug the device to USB to enter in calibration mode







7. Move all the 4 arms to the upper position to calibrate the Axis



8. Make sure the 2 throttles are on TO/GA position THEN press EACH red buttons to set buttons 9 & 13

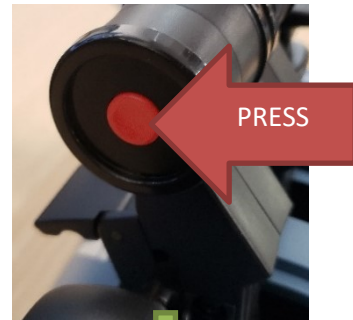
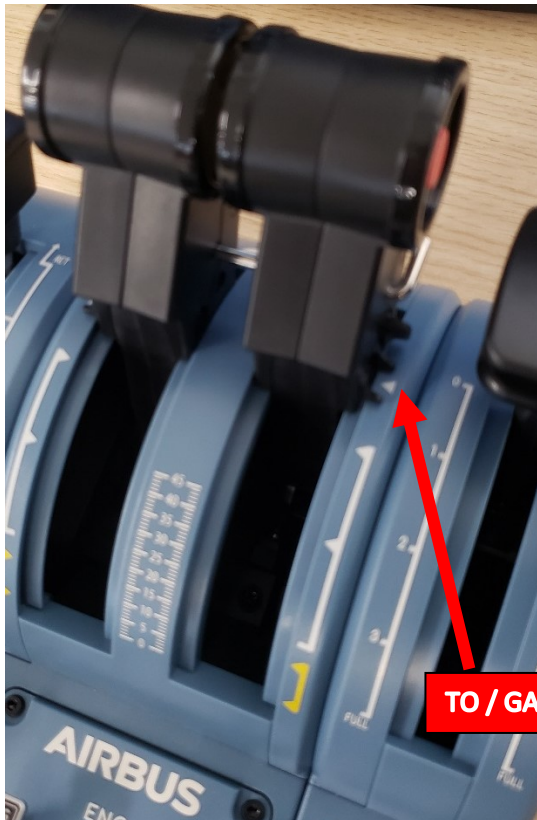



9. Move the 2 throttles to FLEX position THEN press **EACH** red buttons to set buttons 10 & 14

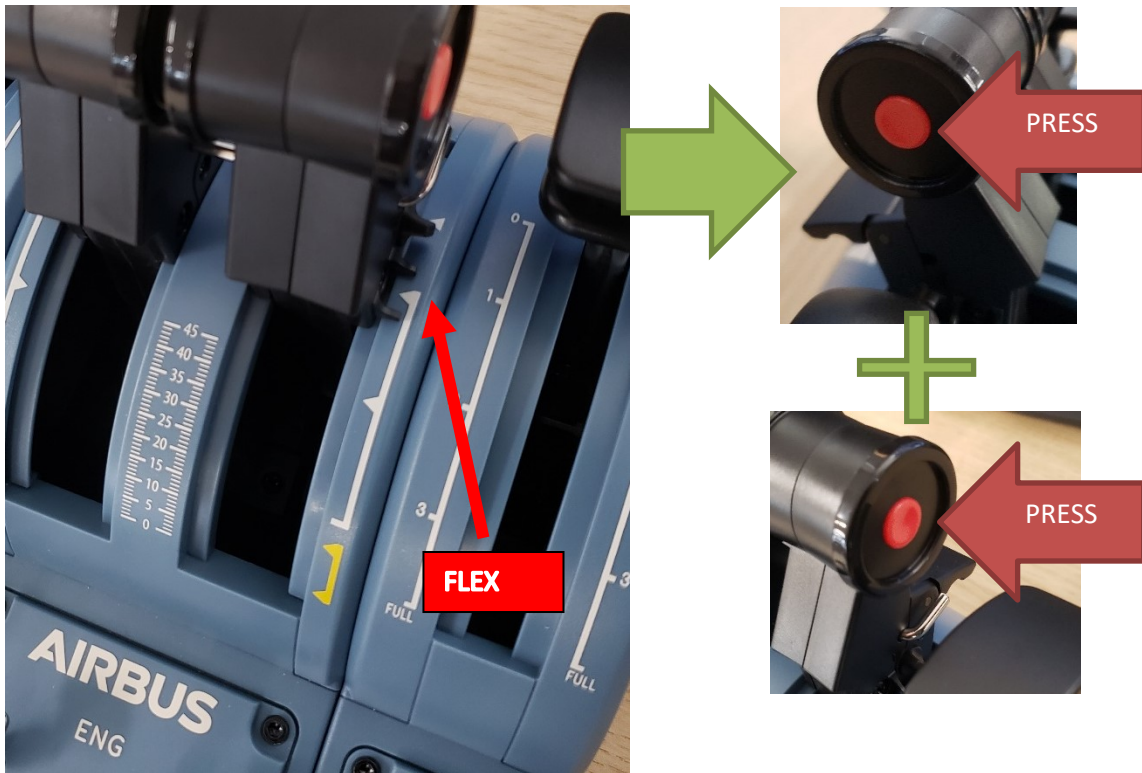

10. Move the throttles to CLB position THEN press both red buttons to set buttons 11 & 15

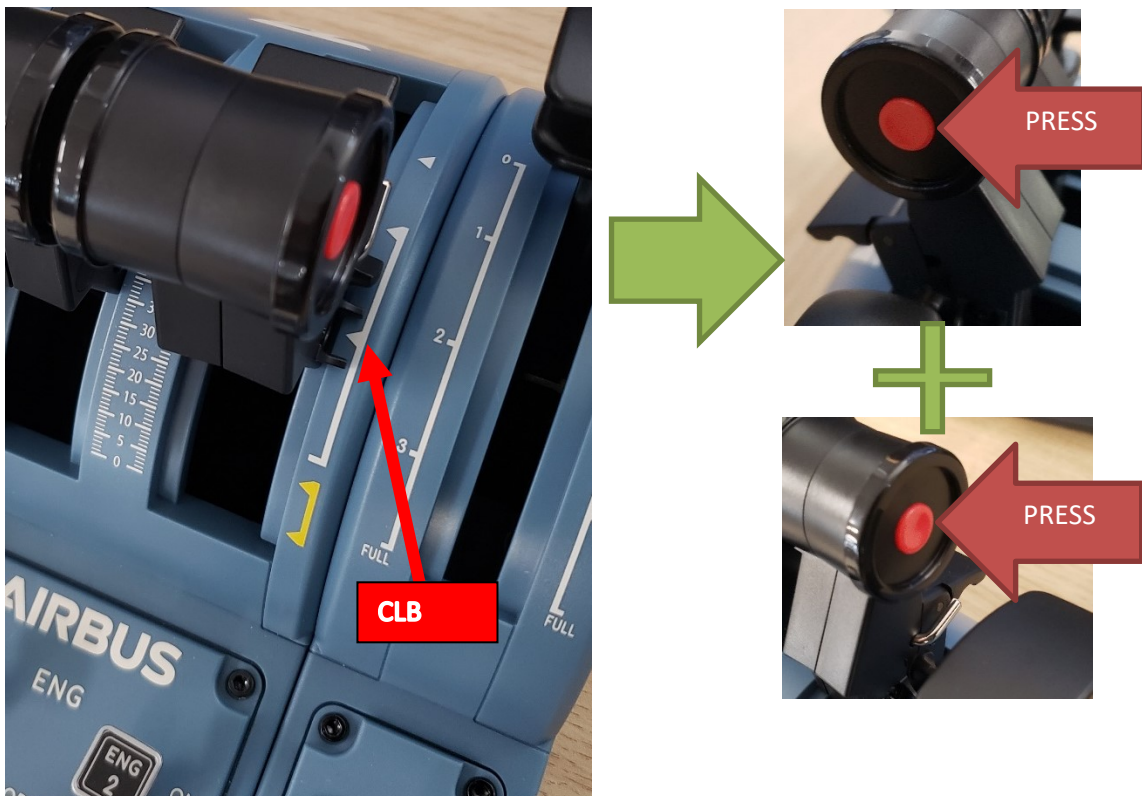



11. Move the 2 throttles to IDLE position THEN press **EACH** red buttons to set buttons 12 & 16

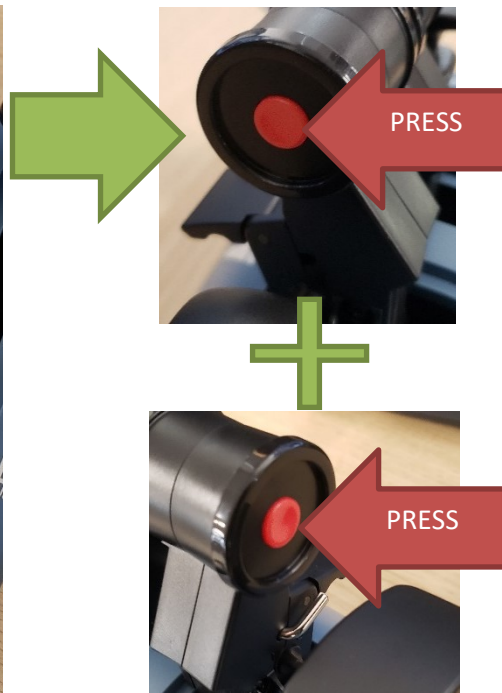





12. Make sure the spoiler arm is on RET position, activate Landing Gear, then deactivate it (UP then DOWN) to set button 27

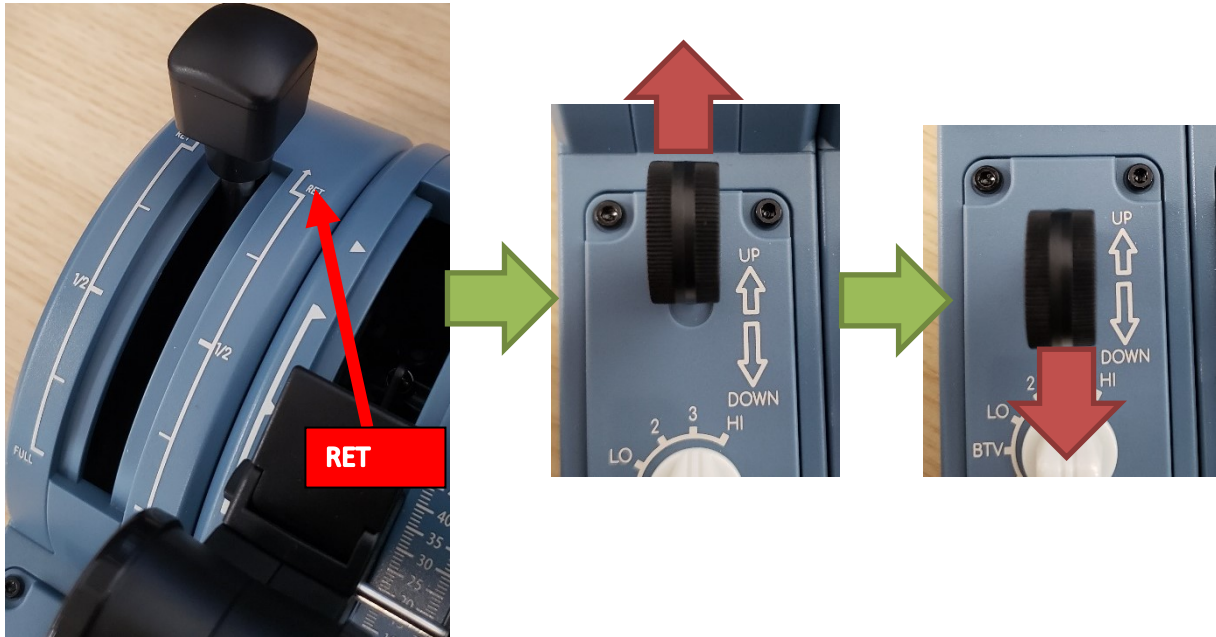

13. Move the spoiler arm to 3/4 position, activate Landing Gear, then deactivate it (UP then DOWN) to set button 28

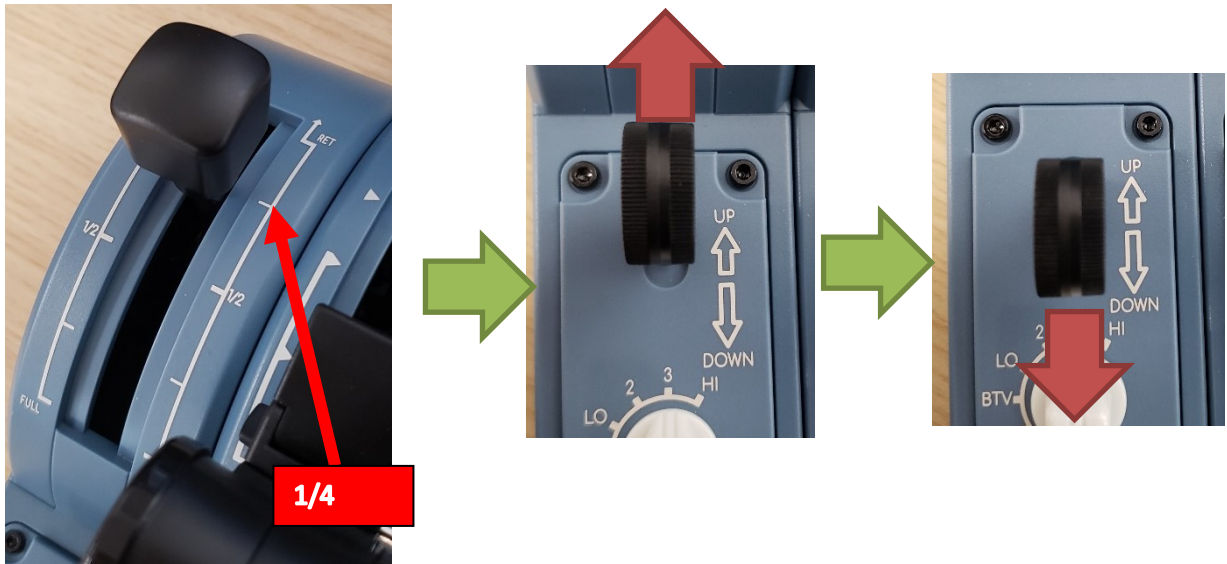



14. Move the spoiler arm to 1/2 position, activate Landing Gear, then deactivate it (UP then DOWN) to set button 29

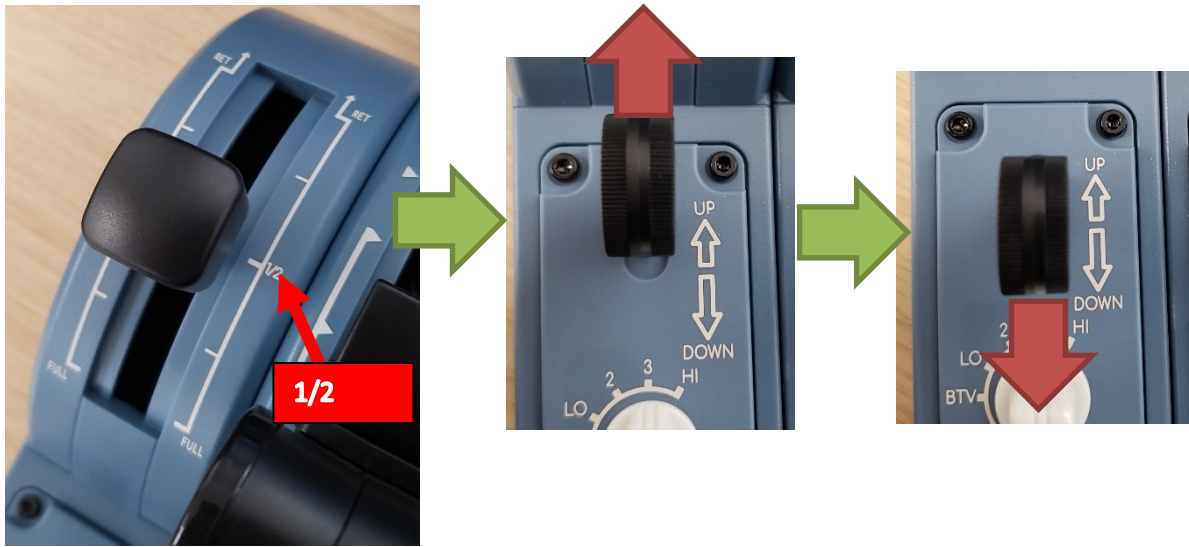

15. Move the spoiler arm to 3/4 position, activate Landing Gear, then deactivate it (UP then DOWN) to set button 30

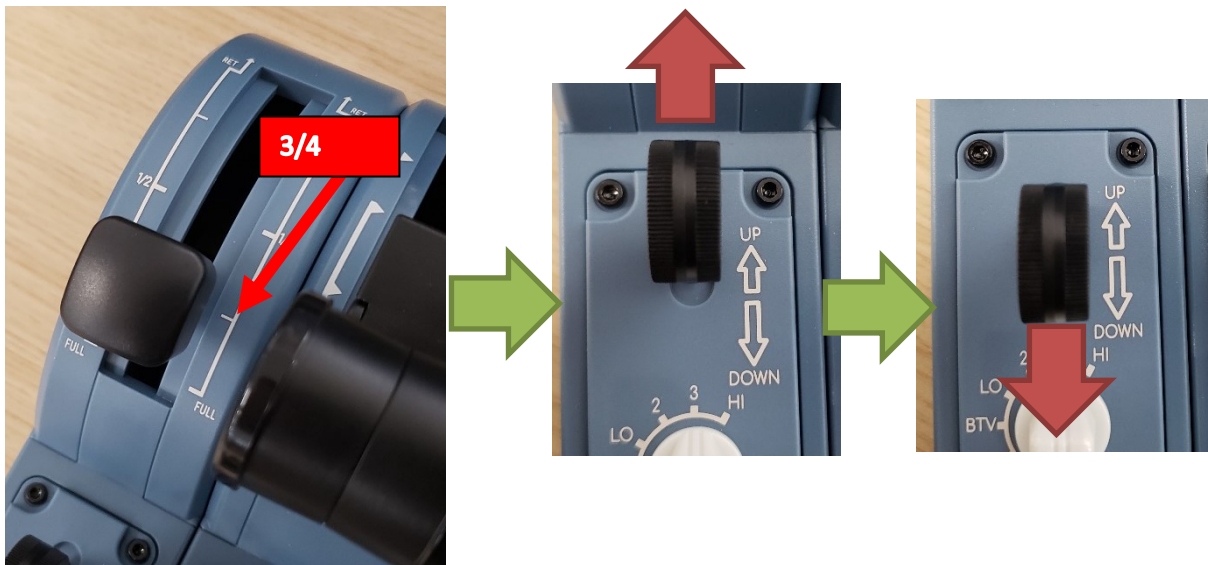





16. Move the spoiler arm to FULL position, activate Landing Gear, then deactivate it (UP then DOWN) to set button 31

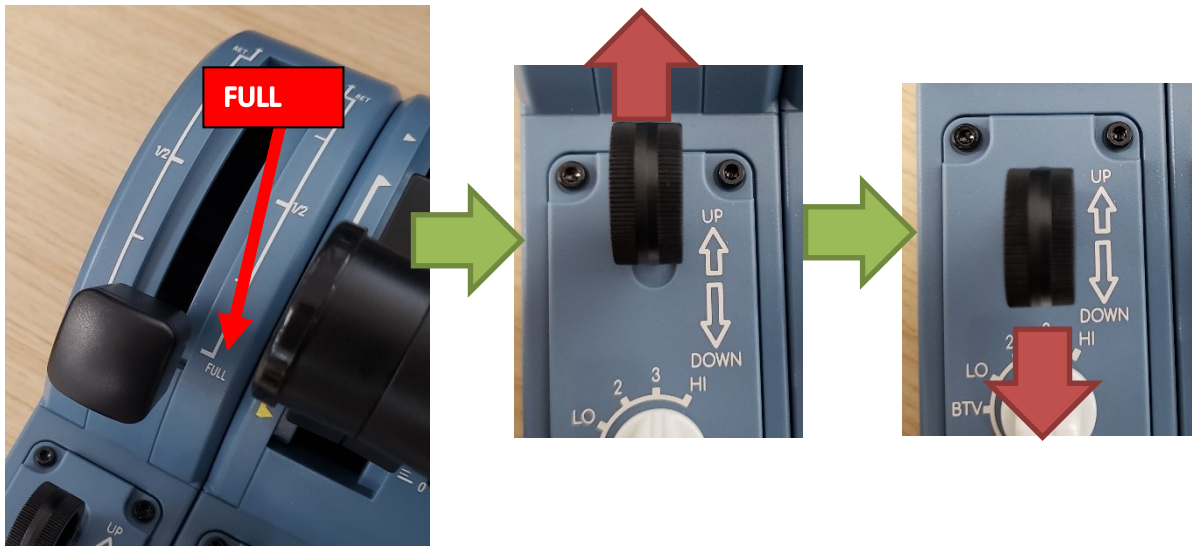

17. Press simultaneously firefault1 and firefault2 button to save the calibration inside the device





18. Remove the crossbar

19.

